

LEŚMIANA III  
Budynek B1

LOKAL K4/M11



PIĘTRO III

POWIERZCHNIA LOKALU:

64,84 m<sup>2</sup>

POWIERZCHNIA BALKONU:

7,38 m<sup>2</sup>

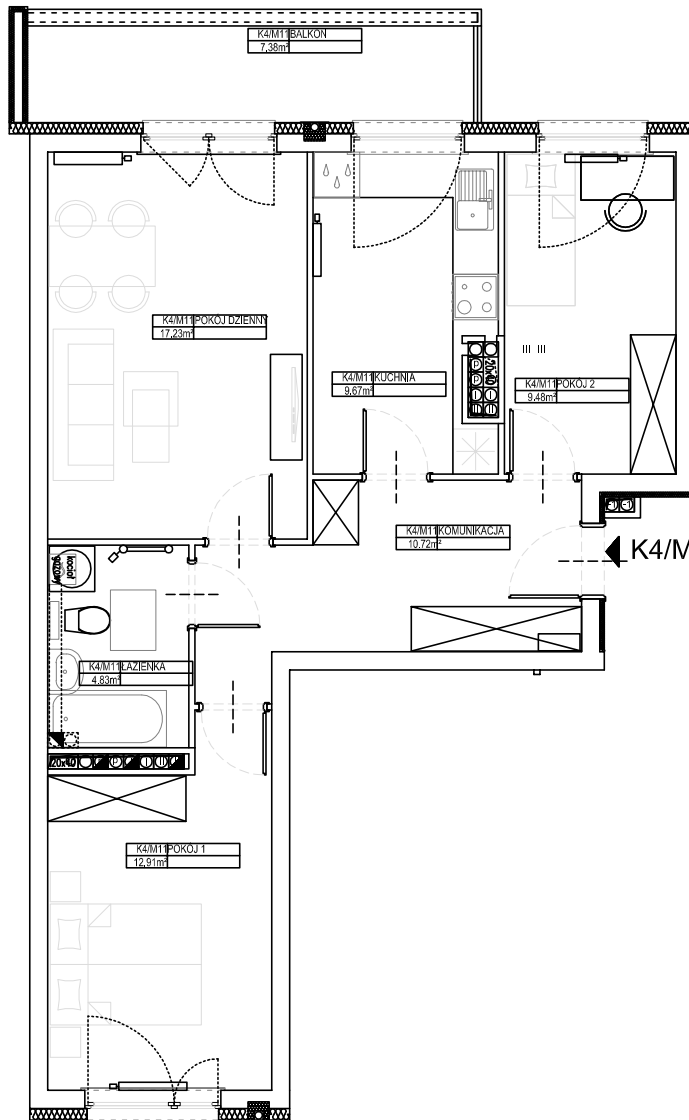

← K4/M11-64,84m<sup>2</sup>

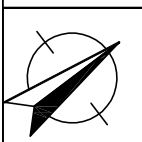

SKALA 1:100